



## Centra Security Systems (UK)

www.centrasecurity.co.uk

# HandKey® II

## Biometric Hand Geometry Reader

### The no-compromise security solution is at hand.

The HandKey® II biometric reader from Schlage utilizes field-proven hand geometry technology. It maps and verifies the size and shape of a person's hand in less than one second and allows access only to authorized people without the hassle of using a card or key.

HandKey II hand geometry technology provides a more economical solution than card-based systems because your hand is your card. Not only is the level of security increased using biometrics, but there are fewer lost or stolen cards and administrative costs are reduced.

Schlage biometric solutions brings the true security and convenience of biometric technology to any access control application. The HandKey II can be used as a stand-alone unit or as part of a networked system. Tens of thousands of HandKeys are already installed in applications that range from universities and day care centers to airports and prisons. Users appreciate how easy the system is to use and the convenience of not having to keep track of a credential.



### BENEFITS

- Field proven in high volume applications
- Saves money over card-based systems
- Easy to use and install
- Increases convenience by eliminating cards
- Integrates into existing systems
- BioCote® antimicrobial agent is applied to the platen of each unit
- A blue hand outline printed on the platen makes using the HandKey easier to use

### Door control and monitoring

Each HandKey II is a complete, integrated door controller providing lock operation, request-for-exit and alarm monitoring. Biometric templates and decision-making capability reside locally, ensuring your doors are always secure and will continue to operate properly even if all communication to the main access control system is lost.

### Features of the HandKey II include:

- Door operation and monitoring
- Card reader input
- Request for exit
- Tamper switch
- Memory expansion from 512 (standard) to 32,512 users
- RS-232 printer output
- Stand alone or networked operation
- Card reader emulation mode
- Multiple auxiliary inputs and outputs
- Outdoor version available
- Optional modem or Ethernet module

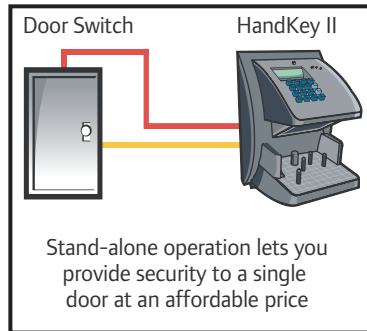

### Stand-alone or fully integrated

HandKey readers can be used as a stand-alone unit or as part of an integrated access control system. The units easily integrate into existing systems using the card reader emulation mode. Or, by using the HandNet software for template management, thousands of units can be linked together to form a system that communicates alarms and transactions in real time, provides activity, user and systems reports, and allows supervised user enrollment and deletions at any reader.

A variety of communications options, including dial-up modems and Ethernet, allow you to design a system that's right for your facilities.

### Antimicrobial Protection

A BioCote® antimicrobial agent applied during manufacturing of the HandKey provides a durable, safe and hygienic finish that keeps the platen's surface cleaner and more hygienic.

### Blue Hand Outline

The HandKey comes standard with a blue hand outline printed on the platen. This hand outline will help users place their hand consistently in the right place on the platen when using the terminal and decrease initial enrollment time.

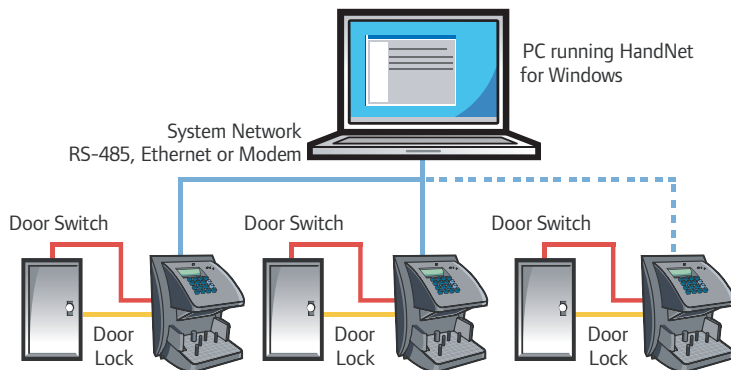

HandKey® is a registered trademark of Schlage. Specifications subject to change. Please check with your system vendor for details.

### SPECIFICATIONS

<b>Part Number</b>	HK-2
<b>Size</b>	8.85 in (22.3 cm) wide 11.65 in (29.6 cm) high 8.55 in (21.7 cm) deep
<b>Weight</b>	6 lbs (2.7 kg)
<b>Power</b>	12 to 24 VDC or 12 to 24 VAC 50-60 Hz, 7 watts
<b>Environment</b>	Operating: 32°F to 113°F (0°C to 45°C) Relative Humidity: 20% to 80% NC Non-operating (storage): 14°F to 140°F (-10°C to 60°C) Relative Humidity: 5% to 85% NC
<b>Verification Time</b>	Less than one second
<b>Memory Retention</b>	Up to 5 years via the standard internal lithium battery.
<b>Transaction Storage</b>	5120 transactions
<b>ID Number Length</b>	1 to 10 digits from keypad or card
<b>User Capacity</b>	512 users expandable to 32,512 users
<b>Template Size</b>	9 bytes
<b>Communications</b>	RS-485 (4 and 2 wire) RS-232 Serial Printer Support or network communications
<b>Baud Rate</b>	300 to 28.8 Kbps
<b>Card Reader Input</b>	Proximity, Weigand, Magnetic Stripe, Bar Code (5 VDC provided by HandReader)
<b>Card Reader Output</b>	Weigand, Magnetic Stripe, Bar Code
<b>Duress Code</b>	1 leading digit (user definable)
<b>Regulatory</b>	FCC, CE, UL294
<b>Door Controls</b>	Request to Exit input (switch or keypad), Door Switch input, Door Lock output. (open collector, 5 VDC present, sinks to ground, 100 mA max)
<b>Alarm Monitoring</b>	Tamper, Door Forced, Duress
<b>Event Monitoring</b>	There are a variety of monitoring options including events such as: Invalid ID, Time Zone Violation, ID Refused, Try Again, PowerFailure
<b>Time Zones</b>	62 user definable time zones Unlimited holidays
<b>Auxiliary Outputs</b>	3 user definable (open collector, 5 VDC present, sinks to ground, 100 mA max)
<b>Auxiliary Inputs</b>	2 user definable (open collector, 5 VDC present, sinks to ground, 100 mA max)
<b>Options</b>	BB-200 Operational Battery Backup CR-2 Magnetic Stripe Card Reader DC-102 Data Converter EM-801 Memory Expansion - 9,728 users EM-803 Memory Expansion - 32,512 users EN-200 Ethernet Communications Module KP-201 Auxiliary Keypad MD-500 High Speed Internal Modem PROX HID Proximity Reader

